

[VIEW 3D MODEL](#)

Roof	Area	Total	Length
Roof Facets	1677 ft ²	3	-
Ridges / Hips	-	2	57' 5"
Valleys	-	0	-
Rakes	-	7	73' 4"
Eaves	-	3	115' 5"
Flashing	-	6	9' 3"
Step Flashing	-	6	16' 10"
Drip Edge/Perimeter	-	-	188' 10"

Roof Pitch*	Area	Percentage
5 / 12	1677 ft ²	100%

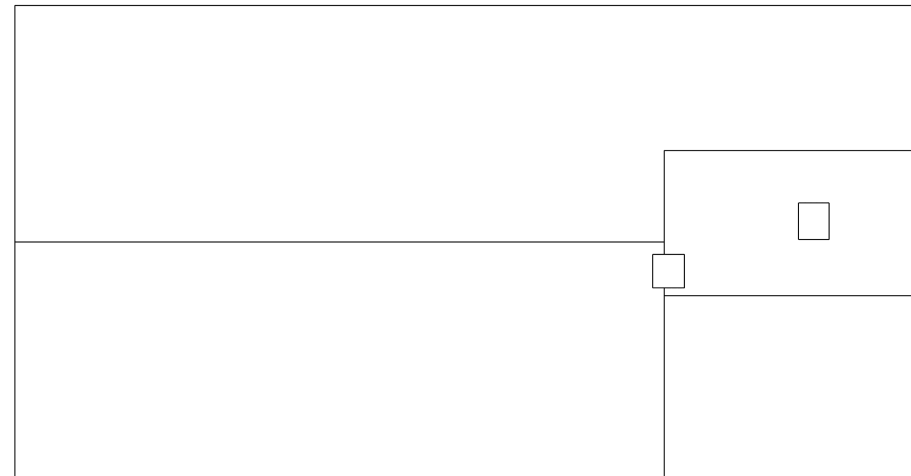

Example Waste Factor Calculations

	Zero Waste	+5%	+10%	+15%	+20%
Area	1677 ft ²	1761 ft ²	1845 ft ²	1929 ft ²	2012 ft ²
Squares	17	17 ² / ₃	18 ² / ₃	19 ¹ / ₃	20 ¹ / ₃

The table above provides the total roof area of a given property using waste percentages as noted. Please consider that area values and specific waste factors can be influenced by the size and complexity of the property, captured image quality, specific roofing techniques, and your own level of expertise. Additional square footage for Hip, Ridge, and Starter shingles are not included in this waste factor and will require additional materials. This table is only intended to make common waste calculations easier and should not be interpreted as recommendations.

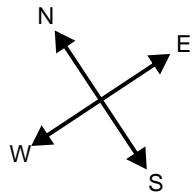

Number of Stories: 1

Footprint Perimeter: 163' 7"

Footprint Area: 1290 ft²

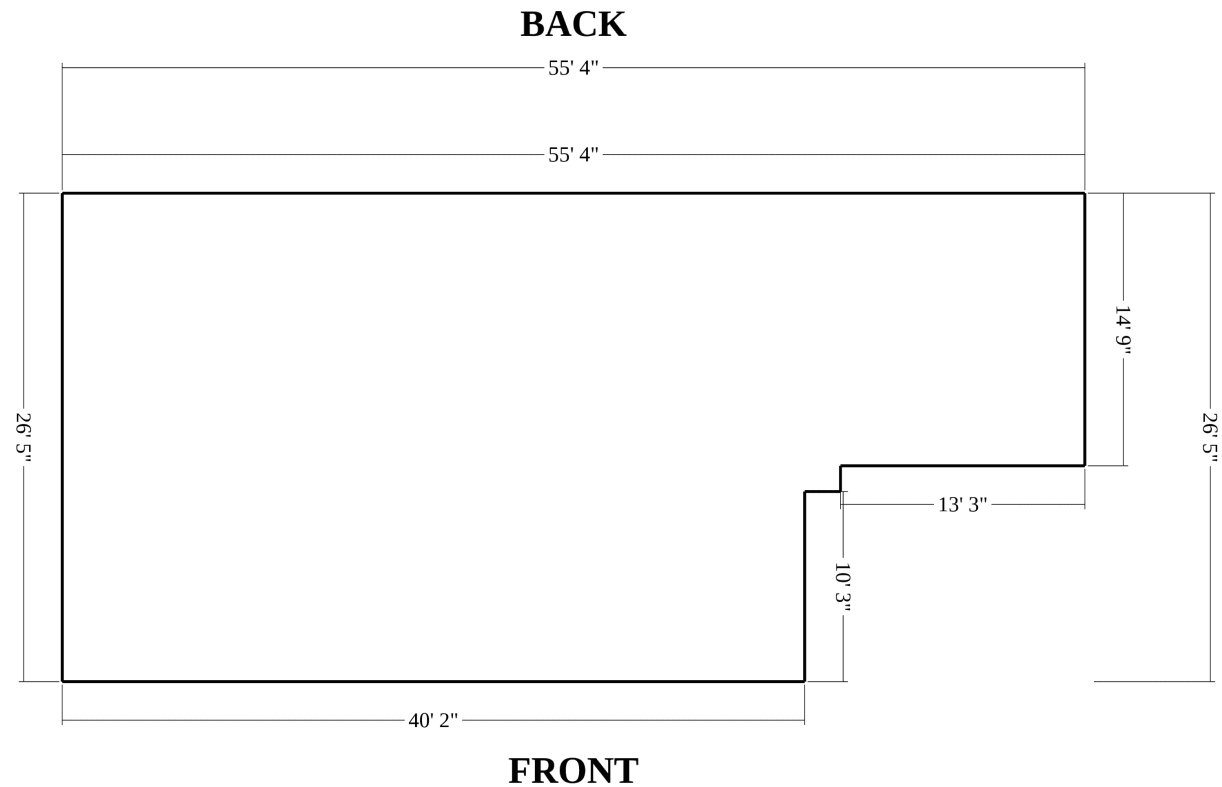

	Cornice Returns	Length	Count
	Returns Story 1	2'	1
	Total	2'	1

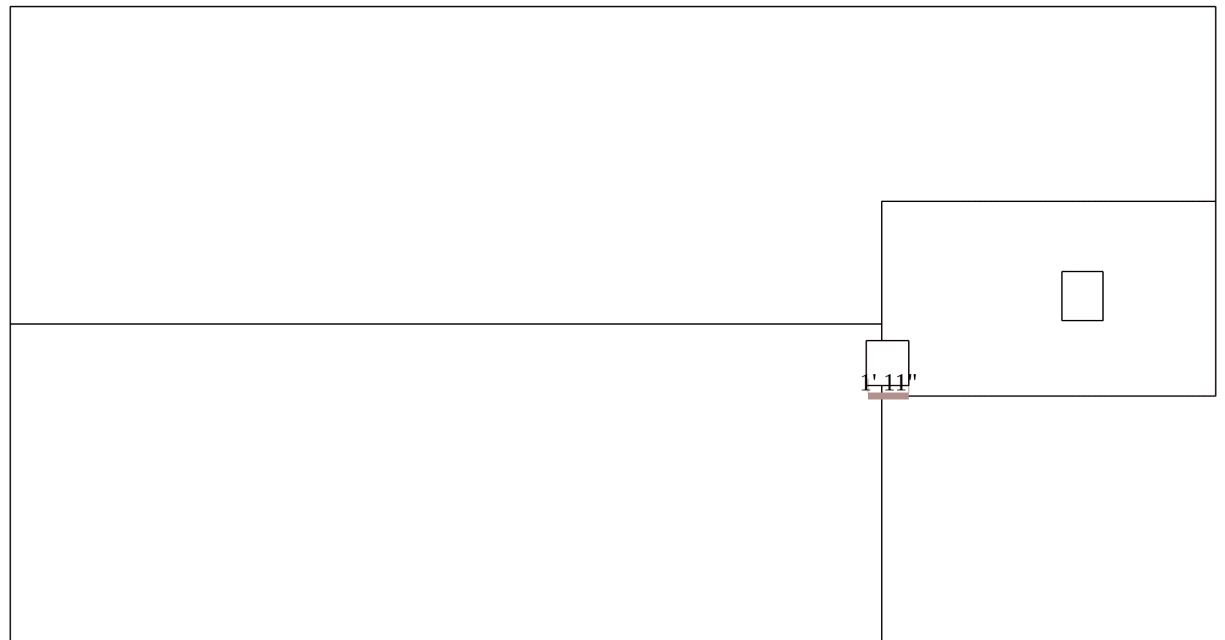

Soffit Summary

Depth	Type	Count	Total Length	Total Area
1" - 6"	eaves	1	1' 11"	1 ft ²
6" - 12"	rakes	5	52' 7"	34 ft ²
12" - 18"	rakes	2	20' 1"	28 ft ²
18" - 24"	eaves	3	108' 9"	206 ft ²
Totals			183' 5"	269 ft ²

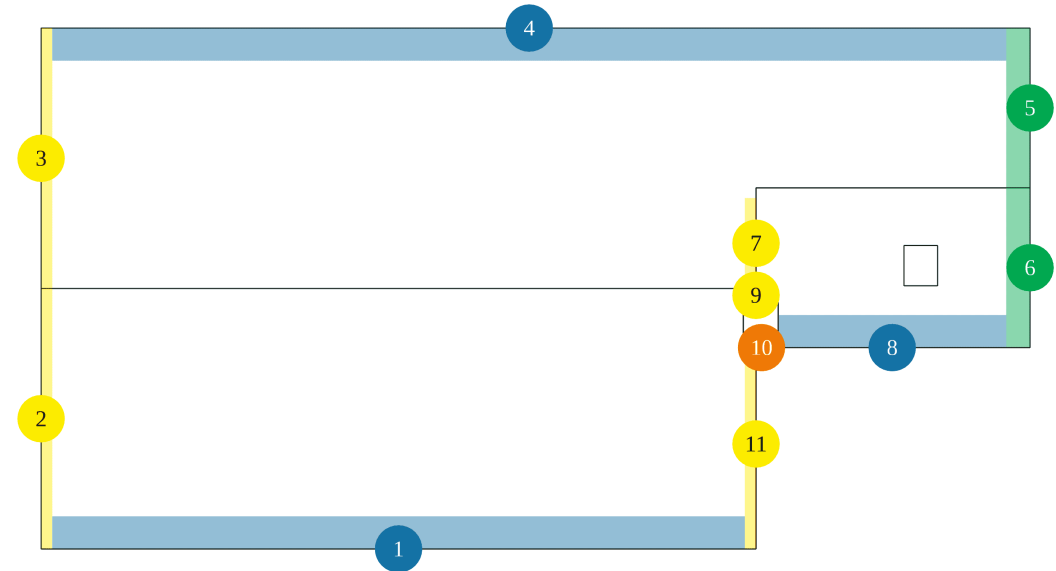

Soffit Breakdown

	num	Type	Depth	Length	Area	Pitch
●	1	eave	23"	40' 2"	76 ft ²	5 / 12
●	2	rake	8"	16' 5"	11 ft ²	5 / 12
●	3	rake	8"	16' 5"	11 ft ²	5 / 12
●	4	eave	23"	55' 4"	105 ft ²	5 / 12
●	5	rake	17"	10' 1"	14 ft ²	5 / 12
●	6	rake	17"	10' 1"	14 ft ²	5 / 12
●	7	rake	8"	5' 8"	4 ft ²	5 / 12
●	8	eave	23"	13' 3"	25 ft ²	5 / 12
●	9	rake	8"	10"	1 ft ²	5 / 12
●	10	eave	6"	1' 11"	1 ft ²	5 / 12
●	11	rake	8"	13' 3"	9 ft ²	5 / 12

Ø Feature is too small to label on the plan diagram

Roof	Length
Ridges (RI)	57' 5"
Hips (H)	-
Valleys (V)	-
Rakes (RA)	73' 4"
Eaves (E)	115' 5"
Flashing (F)*	9' 3"
Step Flashing (SF)*	16' 10"
Transition Line (TL)	-

*Please view the 3D model for more detail (e.g. flashing, step flashing and some other roof lines may be difficult to see on the PDF)

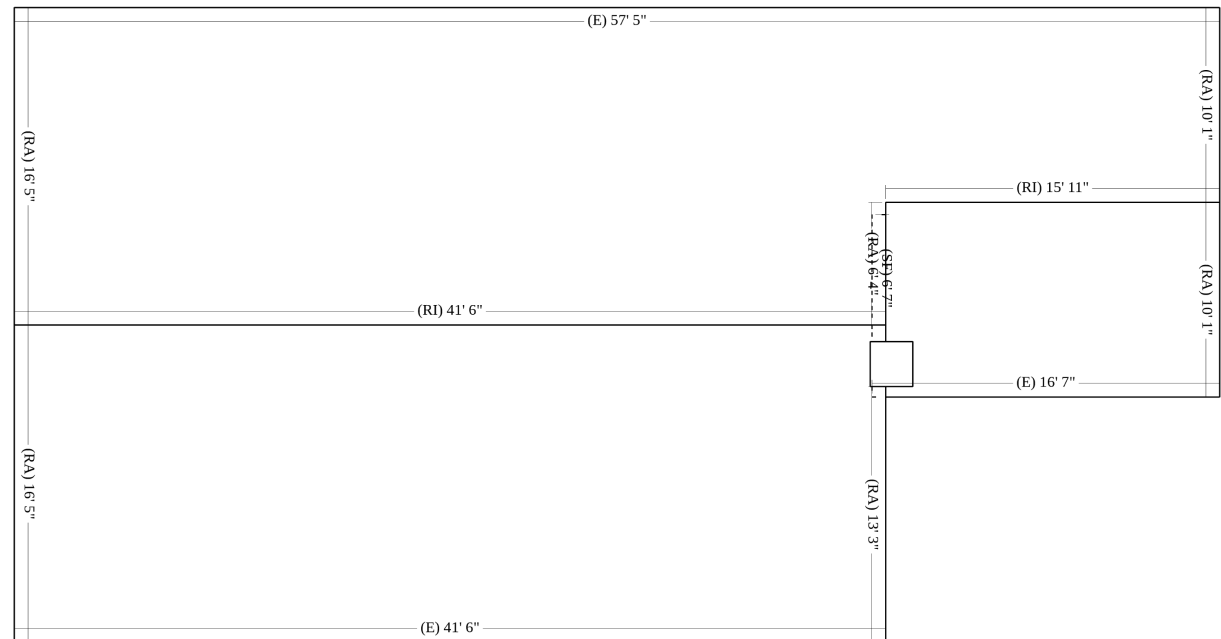

Roof Facets

Facet	Area	Pitch
RF-1	679 ft ²	5/12
RF-2	157 ft ²	5/12
RF-3	841 ft ²	5/12

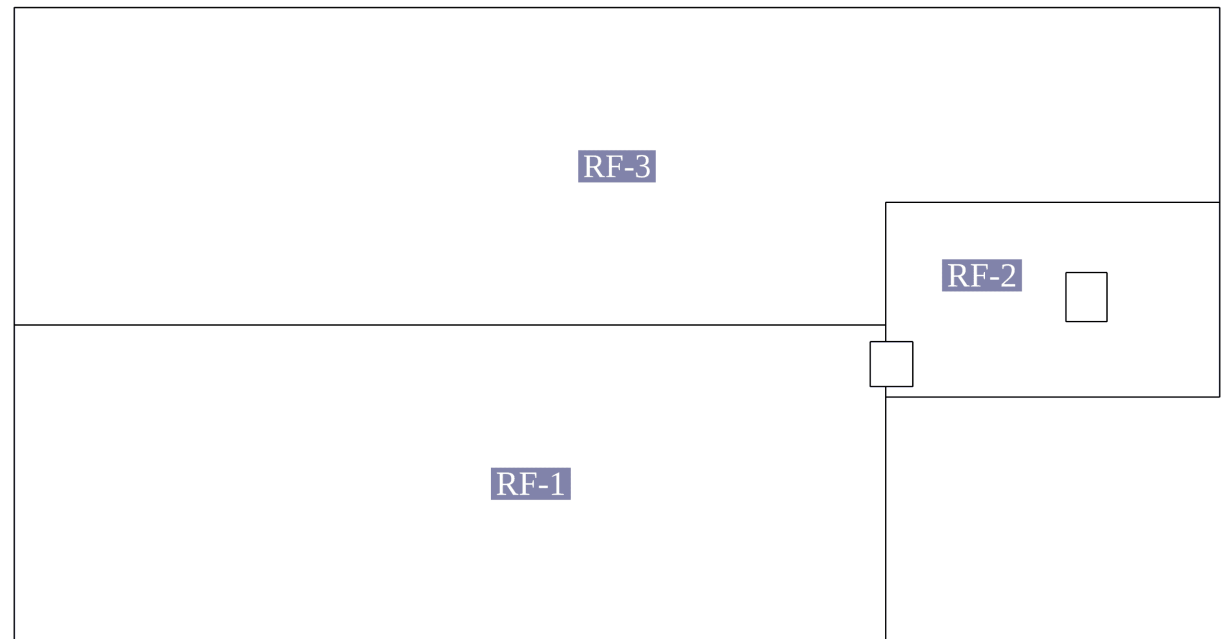

Roof	Facets	Total
Total	3	1677 ft ²

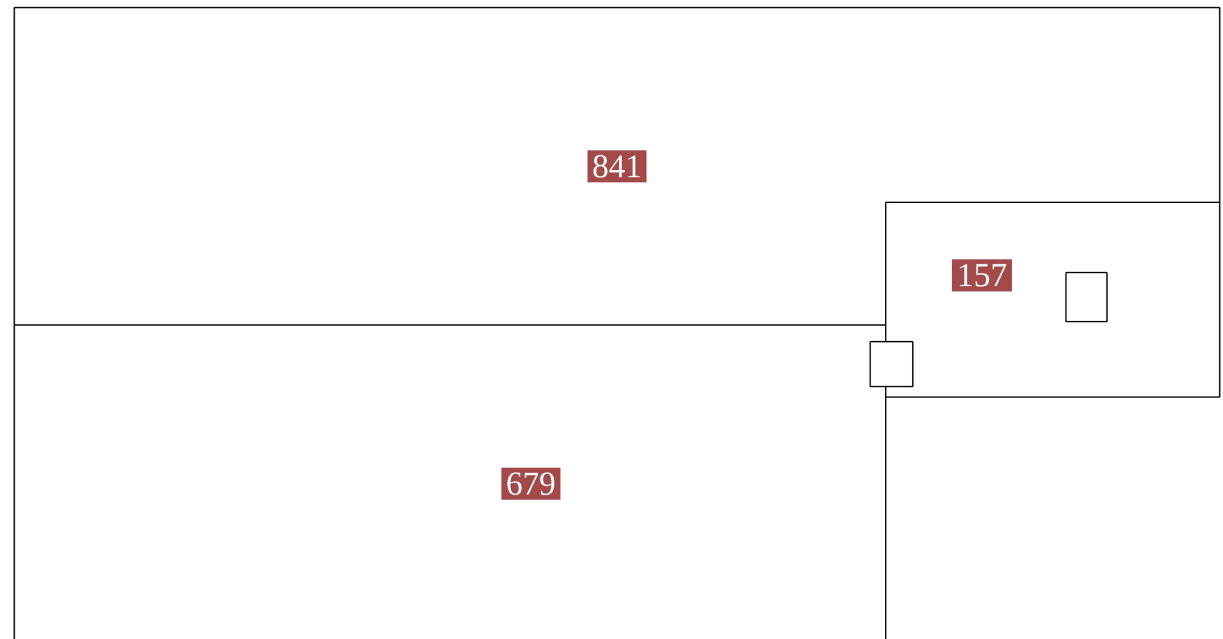

Roof Pitch	Area	Percentage
5 / 12	1677 ft ²	100%

